

WITH 5-YEAR WARRANTY

Owner's Manual

Marlin[®]

BOLT ACTION

Rimfire Rifle

IMPORTANT: Never attempt to load your rifle with ammunition that does not meet the cartridge designation stamped on the barrel. If this rifle is chambered for either 22 Winchester Magnum Rimfire or 17 Hornady Magnum Rimfire, do not attempt to use 22 Short, Long or Long Rifle cartridges.

IMPORTANT

This manual contains operating, care and maintenance instructions. To assure safe operation, any user of this firearm must read this manual carefully. Failure to follow the instructions and warnings in this manual can cause accidents resulting in injury or death. This manual should always accompany this firearm, and be transferred with it upon change of ownership.

The warranty card attached to the cover must be filled out and mailed within 10 days of purchase.

WARNING: KEEP THIS FIREARM OUT OF THE REACH OF CHILDREN, UNAUTHORIZED INDIVIDUALS, AND OTHERS UNFAMILIAR WITH THE SAFE HANDLING OF FIREARMS.

LIMITED WARRANTY AND CERTIFICATE OF OWNERSHIP

To insure warranty protection, this card must be completed and mailed within 10 days of purchase.

Model _____ **Date of Purchase** _____
Serial Number _____

I have read the Owner's Manual and request registration of my warranty. _____
(signature of owner)

Please Print

Owner _____ **Address** _____

City _____ **State** _____ **Zip Code** _____

e-mail _____

Name of Store where purchased _____ **City** _____ **State** _____

To help us provide new and better products we would appreciate your answers to the following questions.

Your Occupation

- Farm
- Student
- Office
- Industrial
- Professional
- Managerial

Your Age Group

- Under 18
- 18-24
- 25-34
- 35-49
- 50+

Which of these influenced your purchase?

- Previous experience with product
- Brand reputation
- Marlin web site
- Marlin advertisement
- Marlin catalog

Was this product a gift?

- Yes
- No



MFC
 P.O. Box 248
 North Haven, CT 06473-0903



PLACE
 STAMP
 HERE

LIMITED WARRANTY

The Marlin Firearms Company
**FIVE YEAR LIMITED WARRANTY AGAINST
 DEFECTS IN MATERIAL & WORKMANSHIP**

This firearm warranty is good only to the ORIGINAL OWNER who has registered his ownership with The Marlin Firearms Company at 100 Kenna Drive, North Haven, Connecticut.

WARRANTY and CERTIFICATE OF OWNERSHIP card **must** be completed and mailed to The Marlin Firearms Company at the above address WITHIN TEN (10) DAYS of purchase to insure the protection of the warranty. NOTICE of defect in materials and/or workmanship **must** be received by the company WITHIN FIVE (5) YEARS from the date of purchase.

Normal wear, or damage resulting from neglect, abuse, alteration, or repairs not made or authorized by The Marlin Firearms Company or use of non-Marlin parts are not covered by the warranty.

THIS WARRANTY GIVES YOU SPECIFIC LEGAL RIGHTS, AND YOU MAY ALSO HAVE OTHER RIGHTS WHICH VARY FROM STATE TO STATE.

**MARLIN'S PERFORMANCE UNDER
 THE ABOVE WARRANTY**

1. After notice of defect in material and/or workmanship is received by The Marlin Firearms Company, Marlin shall send instructions for shipment of the firearm; and repairs will be made and the firearm returned within a reasonable time after the firearm is received. Cost of shipping, insurance charges, etc. involved in returning the firearm to the company shall be prepaid by the original owner.
2. Cost of parts and labor performed shall be provided without charge by The Marlin Firearms Company.
3. If The Marlin Firearms Company, after receipt of the firearm, determines that the defects in material and/or workmanship were the result of abuse and/or neglect, or otherwise not covered by the warranty set forth above, Marlin shall notify such owner to that effect and give an estimate for repair. In such cases, repair, return shipping and insurance charges, etc. shall be paid by such owner.
4. In the event that The Marlin Firearms Company is unable to make warranty repairs to the firearm, it shall, within a reasonable time after its receipt, notify the owner to that effect and give him the option either to receive a replacement of the same model, if then available in its inventory, or to receive a refund, either of which, if feasible, will be made through the store of purchase.

The Marlin Firearms Company
 100 Kenna Drive, North Haven, CT 06473-0905
www.marlinfirearms.com

Before You Use This Firearm

It is very important that you read and understand this manual before using your new rifle. Warnings should be read and heeded carefully. Also follow the safety rules listed in "Marlin's Guide to Gun Safety", printed in this manual.

- **WARNING:** Marlin firearms are designed and manufactured to handle standard factory-loaded ammunition which conforms to SAAMI (Sporting Arms and Ammunition Manufacturers' Institute Inc.) standards with dependability and safety. Due to the many bullet and load options available, the element of judgement involved, the skill required, and the fact that serious injuries have resulted from dangerous handloads, Marlin does not make any recommendations with regard to handloaded ammunition.
- **WARNING:** Your rifle was shipped completely assembled and should not be used or disassembled without fully reading and understanding the instructions in this manual.
- **WARNING:** It is a violation of federal law to alter or deface the serial number of any firearm.

How Your Rifle is Made

Your rifle has been made to Marlin's strictest standards of safety and reliability. It has been proof tested with a high pressure load, function fired, and sighted-in at the factory. Built with tradition and engineered to last, your rifle is the product of over 100 years of Marlin technology.

How to Operate the Safety

- **WARNING:** Prior to firing, know and understand the operation of the safety by practicing with the rifle unloaded.
- **WARNING:** Never put the safety between the SAFE and FIRE positions. Always place it in either the forward position (FIRE) or rearward position (SAFE).

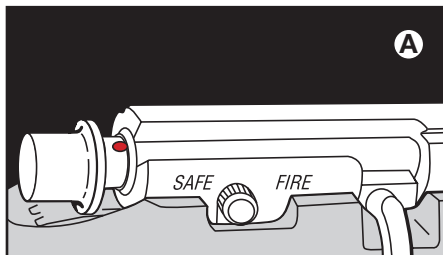

Safe Position

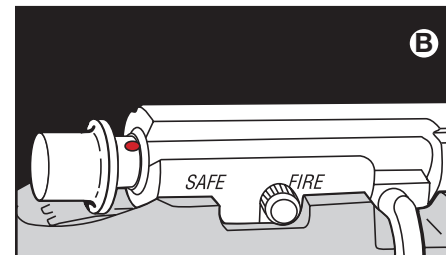

Fire (Off Safe) Position

Unless the safety is in either the forward or rearward position, you cannot be certain whether it is on SAFE or FIRE.

The safety button is round and located on the right side of the receiver behind the bolt handle. The words "FIRE" and "SAFE" are engraved on either side of the safety button. To put your rifle on SAFE, first cock it, by opening and closing the bolt (a red dot on top of the striker knob will be visible). Then pull the safety button back to the rear position (SAFE). The safety is now on SAFE (see A). To move the safety to the FIRE position, push the safety button to the forward position (FIRE). The safety is now in the FIRE position (see B). If the trigger is pulled with the safety button in this position, the rifle will fire.

•**WARNING:** Never disassemble the safety. It has been correctly designed, fitted and tested. Any mechanical device can fail, however, so never rely on the safety to justify careless handling. Never use a firearm with a safety that does not function properly. (See instructions for factory maintenance in this manual.)

Ammunition Note

Your rifle is chambered for 22 rimfire, 22 Winchester Magnum Rimfire, 17 Hornady Magnum Rimfire, or 17 Mach 2. These cartridges are shown below, actual size. None of these cartridges are interchangeable with any other.

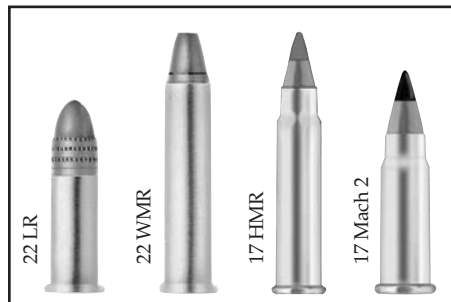

•**WARNING:** Never attempt to load your rifle with ammunition that does not meet the cartridge designation stamped on the barrel. Use only clean, dry, factory-loaded ammunition which conforms to industry standards.

•**WARNING:** Before loading this firearm, always check the bore and chamber to be sure they are free of grease, oil or any other obstruction. Be sure the chamber is empty, bolt is open and the safety is on SAFE. Avoid having your hands near the muzzle of a loaded rifle.

How to Load

Loading A Single Cartridge

Your rifle may be loaded with a single cartridge, provided the magazine is empty. Open the bolt and put the safety on SAFE. Place the cartridge, bullet end toward the muzzle, directly into the chamber.

NOTE: Models 915YS and 915Y are single shot rifles and therefore have no magazine.

Models with Tubular Magazine

•**WARNING:** Never add cartridges to a partially loaded tubular magazine. This rifle

will not function properly unless the inner magazine tube is locked securely in place.

•**WARNING:** Never remove the bolt (See G) while unloading, or when cartridges are in the tubular magazine. Cartridge misplacement can occur.

Open the bolt by lifting the bolt handle and pulling it all the way back. Then, with the safety on SAFE, keeping your fingers

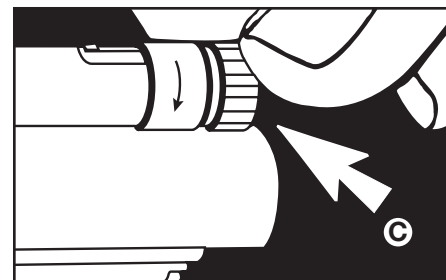

Unlocking the tubular magazine

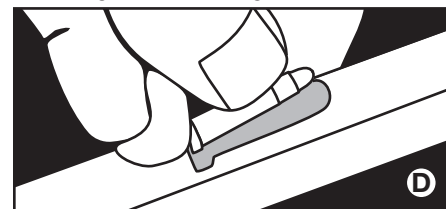

Loading the tubular magazine

away from the muzzle, turn your rifle upside down and unlock the inner magazine tube by turning the knurled locking end plug (see C). Pull the inner tube out until the loading port is open. Insert the cartridges, bullet end toward the muzzle (see D). When you have loaded up to the magazine capacity (12 cartridges for 22 Win. Mag. Rimfire and 17 Hornady Mag. Rimfire models; 25 Short, 19 Long or 17 Long Rifle cartridges for the Model 981T), slide the inner tube back in place, turning it slightly to ease passage over the loaded rounds. **DO NOT FORCE THE TUBE DOWN.** Then rotate the knurled locking end plug to the locked position. Inner tube will not lock in place if the number of cartridges loaded exceeds the stated magazine capacity.

Models with Clip Magazine

Open the bolt by lifting the bolt handle and pulling it all the way back. Then, with the safety on SAFE, remove the magazine by pressing release button shown in (E). Insert up to seven cartridges in the magazine. As you load, push cartridges down and rearward (see F). Replace loaded magazine, being sure it locks in place.

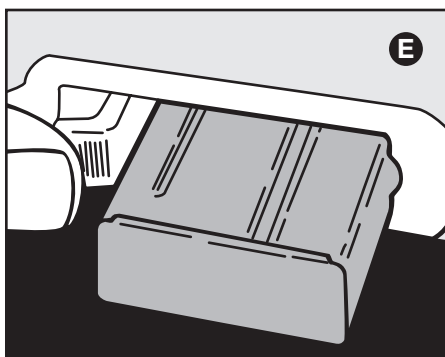

Releasing the clip magazine

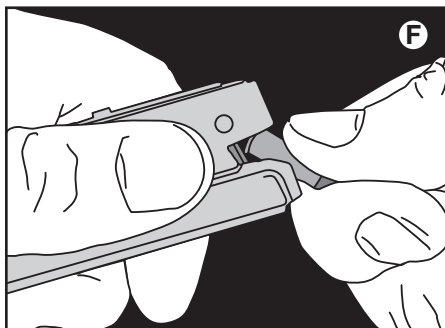

Loading the clip magazine

Cocked and Ready

To chamber a cartridge, lift the bolt handle and pull it all the way back. Then push it all the way forward and down. A red dot on top of the striker knob will signify that *the gun is cocked and ready to fire* (See A, page 1).

How To Fire

With the rifle pointed at the target, move the safety to the FIRE position and squeeze the trigger. Open and close the bolt completely for each repeat shot (except Models 915YS and 915Y, which are single shot). If you have not fired all cartridges at the target, be sure to put the safety on SAFE until you are ready to shoot again.

How to Unload

With the safety on SAFE, and the rifle pointed in a safe direction, open the bolt and eject the loaded cartridge from the chamber.

For models with a tubular magazine, cycle the action repeatedly by opening and closing the bolt, until the ejection of cartridges ceases. When the last cartridge has been ejected, the bright orange plas-

tic follower will be visible in the feed throat. The inner magazine tube **MUST** be locked in place to unload the rifle.

•**WARNING:** Completely open and fully close the bolt several more times to be certain that the chamber and feed mechanism are empty.

For models with a clip magazine, with the bolt still open, remove the magazine, and do not reinsert it until you are ready to shoot again. Finally, inspect interior of receiver visually. Leave the bolt in the open position.

What to do if Rifle Fails to Fire

Misfires

If you squeeze the trigger and the cartridge does not fire, remain in the shooting position and count to 10. Then operate the bolt to eject the misfired cartridge from the gun.

Underpowered Shot

An underpowered shot is unusual if the ammunition is fresh, clean, and factory loaded. However, if you hear an unusual sound or low report, you should stop immediately and proceed as follows:

•**WARNING:** Because the bullet may actually still be in the barrel, you must unload completely and then, with the bolt removed (See G, page 5), use a cleaning rod from the breech end to see if there is any obstruction. If there is, it should be removed by a qualified gunsmith. Otherwise, personal injury or damage could result. Do not remove bolt prior to ensuring rifle is unloaded.

•**WARNING:** Do not attempt to load another cartridge until you have ensured that the barrel and chamber are clear.

Sighting

All models have receivers grooved for telescope sight rings and scopes. Heavy barrel varmint models do not have open sights and require a scope. If you would like to have open sights installed, see a competent gunsmith.

Models with open sights were pre-sighted at the factory. However, due to individual sighting characteristics, minor adjustments may be necessary.

Always ensure the rifle is pointed in a safe direction. Put the rifle on SAFE and open the bolt before making any sight changes.

Rear Sight Adjustment Rule

To make corrections, always remember to move the rear sight in the direction in which you wish to move the center of the group. That is, if you are shooting low, raise the rear sight. If you are shooting to the right, move the rear sight to the left.

For Models Equipped With Adjustable Open Rear Sights

Horizontal Correction (Windage)

Windage adjustments to the rear sight can be made by gently tapping the dovetail portion of the rear sight in the desired direction.

To move the point of impact to the left, move the rear sight base to the left. To move the point of impact to the right, move the rear sight base to the right.

Vertical Correction (Elevation)

To raise the point of impact, raise the rear sight. To lower the point of impact, lower the rear sight. The sight can be raised and lowered by moving the stepped elevator forward and back with your thumb.

For Models Equipped With Screw-Adjustable Rear Sights

Horizontal Correction (Windage)

To move the point of impact to the left or right, loosen the leaf binding screw until you can move the leaf manually. Move the leaf in the appropriate direction, retighten the screw and fire again. Continue this process until your shots are horizontally zeroed-in.

Vertical Correction (Elevation)

To raise the rear sight (if you are shooting low) turn the elevation adjustment screw clockwise. To lower the rear sight (if you are shooting high) turn the elevation adjustment screw counterclockwise. Continue adjusting and firing until your shots are vertically zeroed-in.

For Models Equipped With Fire Sights

Horizontal Correction (Windage) To adjust the point of impact, loosen the dovetail screw until you can move the sight manually. To move the point of impact to the left, move the rear sight base to the left. To move the point of impact to the right, move the rear sight base to the right. Adjustments can be made by gently tapping the dovetail por-

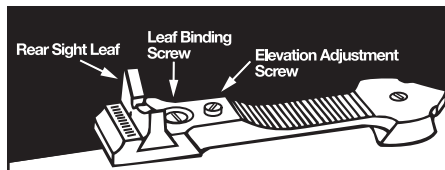

Screw-adjustable rear sight

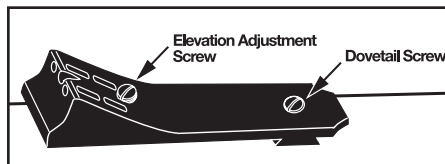

Fire sight

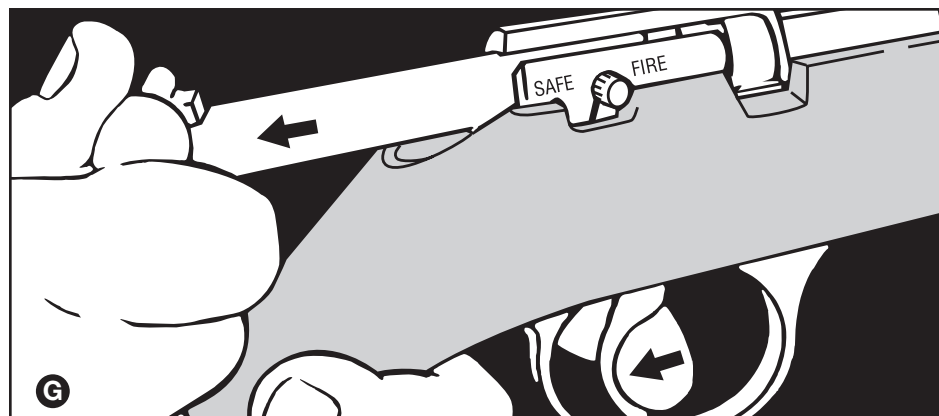

Removing the bolt

tion of the rear sight in the desired direction. Retighten the screw and fire again. Continue this process until your shots are horizontally zeroed-in.

Vertical Correction (Elevation) To raise the rear sight (if you are shooting low) turn the elevation adjustment screw clockwise. To lower the rear sight (if you are shooting high) turn the elevation adjustment screw counterclockwise. Continue adjusting and firing until your shots are vertically zeroed-in.

Scope Mounting

Your rifle has a grooved receiver designed to handle tip-off-type 22 scope bases. They are made by several manufacturers in various heights, to accommodate different objective diameters, and are available through your local gun dealer. You may also order directly from Marlin Gun Service. Call 1-800-544-8892 for more information.

How to Clean Your Rifle

•**WARNING:** Before cleaning your rifle, be certain it is completely unloaded, and the bolt has been removed.

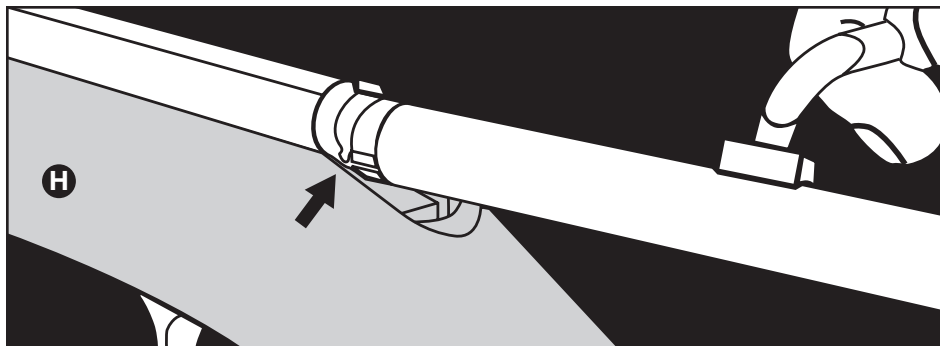

Aligning bolt for reassembly

6

•**WARNING:** Never attempt to wipe down or clean a loaded firearm. Follow instructions under “How to Unload” before cleaning.

NOTE for stainless steel models:

Although stainless steel is corrosion-resistant, it can rust. If the rifle gets wet, dirty, or is subject to excessive handling, remove all moisture and wipe down metal parts with oil or a rust-inhibitor.

Minor scratches can be “buffed out” of stainless steel with a “Scotch-Brite™ Very Fine” pad, available in hardware and automotive supply stores.

With normal use it is not necessary to clean the bore of your rifle. However, if the rifle gets wet, or if foreign material gets into the action or barrel, cleaning as described below is recommended.

Being sure your rifle is unloaded and pointed in a safe direction, open the bolt, pull the trigger fully to the rear and completely withdraw the bolt from the rear of the receiver, as shown in (G).

Clean the bore and barrel by using any standard 22 caliber (17 caliber for Models chambered in 17HMR or 17 Mach 2) commercial cleaning rod and cleaning patches. Clean the barrel with powder solvent and wipe lightly with gun oil after cleaning. Always clean the rifle from the breech (chamber end) to the muzzle.

Caution: Before using any solvent or other gun cleaning product, read the label carefully to be sure it will not damage either the finish or any parts of this firearm.

NOTE ON HEAVY USAGE: When your rifle has fired more than 1,000 rounds or is a year old, lubrication of the trigger mechanism and cocking cam will assure continued smooth operation.

Open the bolt and remove the clip magazine (if your rifle is a clip-loader). Remove the takedown screw on the underside of the forearm, and the forward trigger guard screw. Remove the barreled action from the stock.

Apply a small amount of good quality gun grease to the area shown in I.

Next, open the bolt and apply a small amount of grease to the cocking cam, as shown in J.

If the rifle continues to be fired extensively, repeat this lubrication about every 1,000 rounds or once a year.

NOTE: The safest possible way to store this, or any other Marlin bolt action rifle, is with the bolt removed and kept separately, under lock and key.

To replace the bolt assembly, align the tab on the left forward portion of the bolt (see H), with the corresponding groove in the rear of receiver. With trigger pulled, insert bolt into rear of receiver. Never force the breech bolt into the receiver, as serious damage may result. If you encounter difficulty, remove the bolt and re-check alignment. After cleaning, and before reinserting the bolt, ensure the barrel is clear.

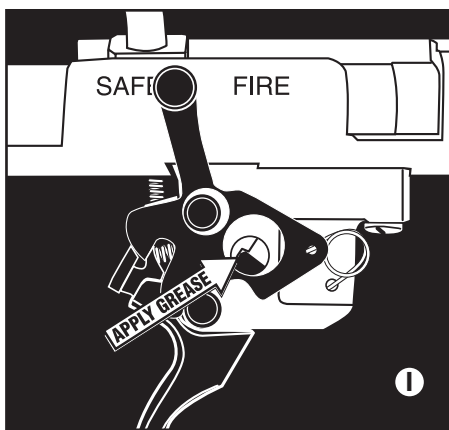

Apply grease.

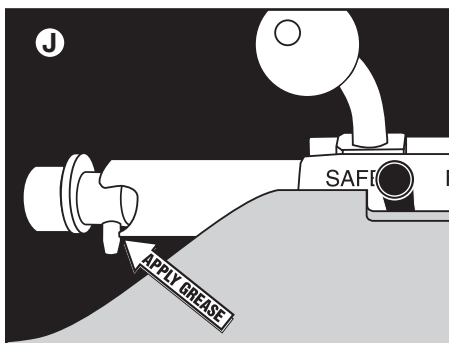

Apply grease.

•**WARNING:** The breech bolt assemblies of Marlin 22 caliber and 17 caliber bolt action rifles are not interchangeable between rifles. (Do not disassemble the breech bolt.) Each breech bolt is individually fitted to the receiver at our factory to assure proper headspacing. Should the bolt assemblies be removed from the rifles for cleaning or safety reasons, be certain that they are reinstalled in the same rifle from which they were removed.

The last three digits of the serial number appearing on the left side of the receiver, are inscribed on the breech bolt with an electric pencil. These three digits will help you to identify the proper rifle for reinstallation of the bolt.

Failure to match the factory fitted breech bolt to the proper rifle could create an unsafe condition that could cause a malfunction of the firearm, or worse, personal injury to the shooter or a bystander.

Use a very thin coat of light oil during below freezing conditions. Condensation droplets will form soon after the rifle is brought into a warm room, or it may become wet during inclement weather. In any case, all moisture should be

removed. Exterior metal finishes may be wiped down with a slightly oiled cloth. For long term storage, lightly oil the bore, barrel and action with gun oil. Remove the bolt (see G) and store it separately. Your firearm should be completely unloaded and stored in a dry area. Never store your firearm in a carrying case.

Repair Instructions

Your firearm has been designed, engineered and manufactured in accordance with Marlin's rigid quality control standards. However, any mechanical device may occasionally require adjustment or repair.

Questions regarding the performance and serviceability of your firearm should be addressed to our Service Department. You should include the Serial Number, Model Number and a full description of the conditions and problems involved.

Warranty Repairs

Our Warranty policy covers all our firearms against defects in workmanship or material for a period of five years from the date of purchase to the original owner. See the inside front cover of this manual for warranty details.

Guns requiring warranty repairs should be returned to the factory. Be sure to follow the "Shipping and Handling" instructions in this manual.

Non-Warranty Repairs

Your local gunsmith may be able to repair your gun. If not, ship it to the factory, following the "Shipping and Handling" instructions in this manual.

After receiving your firearm, we will send you an estimate of the repair cost. Repairs will begin upon receipt of your check or money order. If repairs are not possible, your firearm will be returned.

Shipping and Handling

When sending your firearm to the factory, please follow these instructions:

1. Prior to shipping, be absolutely certain that the firearm is completely unloaded (See "How to Unload").
2. Pack your firearm carefully. Use ample cushioning material and a sturdy outer cardboard box. Do not ship in a special container which you want returned.

3. Accessories such as scopes, scope mounts, gun case, quick-detach type swivels, slings, etc. should be removed prior to returning the firearm.

4. Inside the box, include the following information: model number, serial number, description of damage or problem, and under what conditions problem occurs.

5. *Keep a record of your serial number when returning a firearm.*

6. Clearly mark your return address on the outside of the box and on your instruction sheet.

7. Do not ship live ammunition under any circumstances.

8. Ship your firearm via insured Parcel Post or U.P.S. Shipment must be prepaid and addressed to:

**MFC INC.
ATTN: SERVICE DEPT.
100 KENNA DRIVE
NORTH HAVEN, CONN. 06473**

IMPORTANT

If you have any questions or problems relating to your new Marlin, would like additional information on safe operation, or wish to order parts or accessories, just call our Customer Service Center. A Service Representative can be reached at the number listed below, between 8 A.M. and 4:30 P.M. (Eastern Time), Monday through Friday.

1-800-544-8892
(Toll Free)

Please record the firearm serial number, date of purchase and where purchased below.

Serial #: _____

Date of Purchase: _____

Purchased From: _____

In case of loss or theft, supply this information to the proper authorities.

The Fascinating History of Marlin

Written by the late William S. Brophy, Marlin's Senior Technical Manager and Official Company Historian for many years, this prodigious book details the history of the Marlin Firearms Co. and its products. The hardbound volume contains more than 600 pages and over 1000 illustrations. Must reading for anyone interested in all the models — pistols, rifles and shotguns — made by Marlin, and in the story of more than a century of firearms production in America.

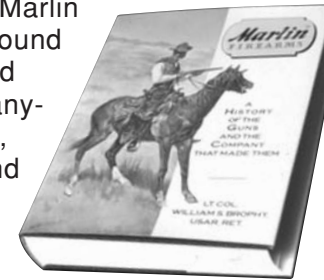

For more information, write:
Marlin Firearms Co.
Department OM
100 Kenna Drive
North Haven, CT 06473

Marlin's Guide to Gun Safety

1. Read and understand the owner's manual before using a firearm.
2. If you are unfamiliar with firearms, attend a firearms safety class taught by a certified instructor.
3. Handle every firearm as if it were loaded and ready to fire.
4. Control the muzzle, and never point a firearm at anything you don't want to shoot.
5. Keep the safety on SAFE until you are ready to shoot.
6. Unless you are hunting, carry your firearm empty, with the action open.
7. Before shooting, be sure you have an adequate backstop. All ammunition is dangerous beyond your line of sight.
8. Avoid ricochets by never shooting at water or any hard, flat surface.
9. Do not run, climb, or jump over an obstacle with a loaded firearm.
10. Do not climb into or out of a tree or tree stand with a loaded firearm.
Do not allow others to pass loaded firearms to you while in a tree stand.
11. Do not enter or ride in a motor vehicle with loaded firearms.
12. Do not lean a loaded firearm against anything.
13. Do not bump, drop or jar a loaded firearm.
14. Do not pull a firearm toward you by the muzzle.
15. Wear hearing protectors when shooting.
16. Wear impact-protective glasses when shooting, disassembling or cleaning firearms.
17. Avoid alcoholic beverages and drugs before and during shooting.
18. Use only ammunition of the correct gauge, caliber, size and bullet shape for your firearm.
19. Do not use damaged, dirty, modified, or improperly handloaded ammunition.
20. Keep the barrel and mechanism of the firearm free of obstructions.
21. Do not use a firearm that fails to function properly. Do not try to force a jammed action.
22. Be sure no one is in the path of ejecting shells or cartridges.
23. Do not interchange parts between firearms, and be sure disassembly and reassembly are correct and complete.
24. Before cleaning, be sure the chamber, action and magazine are completely unloaded.
25. Unload firearms before storing, transporting, or leaving unattended.
26. Store firearms and ammunition separately, locked and out of the reach of children.

Failure to follow these rules, or other instructions in this manual, can result in personal injury.

Printed in U.S.A.

WARNING

Children are attracted to and can operate firearms that can cause severe injuries or death.

Prevent child access by always keeping guns locked away and unloaded when not in use. If you keep a loaded firearm where a child obtains and improperly uses it, you may be fined or sent to prison.

ADVERTENCIA

A los niños los atraen las armas de fuego y las pueden hacer funcionar. Ellos pueden causarse lesiones graves y la muerte.

Evite que los niños tengan acceso a las armas de fuego guardándolas siempre con llave y descargadas cuando no las esté utilizando. Si usted tiene un arma de fuego cargada en un lugar en que un niño tiene acceso a ella y la usa indebidamente, le pueden dar una multa o enviarlo a la cárcel.

Health Warning: Discharging of firearms in poorly ventilated areas and handling ammunition may cause exposure to lead and/or lead compounds. Exposure may cause cancer, birth defects or damage to the kidney, nervous, blood forming and reproductive systems. Have adequate ventilation at all times, especially in confined areas. Wash hands thoroughly after shooting, handling ammunition, or cleaning a firearm. Do not eat or smoke during these activities.

Safety Warning: Marlin strongly recommends that you take a hunter safety course, taught by a certified instructor, before you use this firearm. Your State Fish & Game Dept. or a local gun shop can suggest courses in your area.

Safety Warning: Keep this firearm out of the reach of children, unauthorized individuals, and others unfamiliar with the safe handling of firearms.

2/05 456503

Marlin®

BOLT ACTION Rimfire Rifle

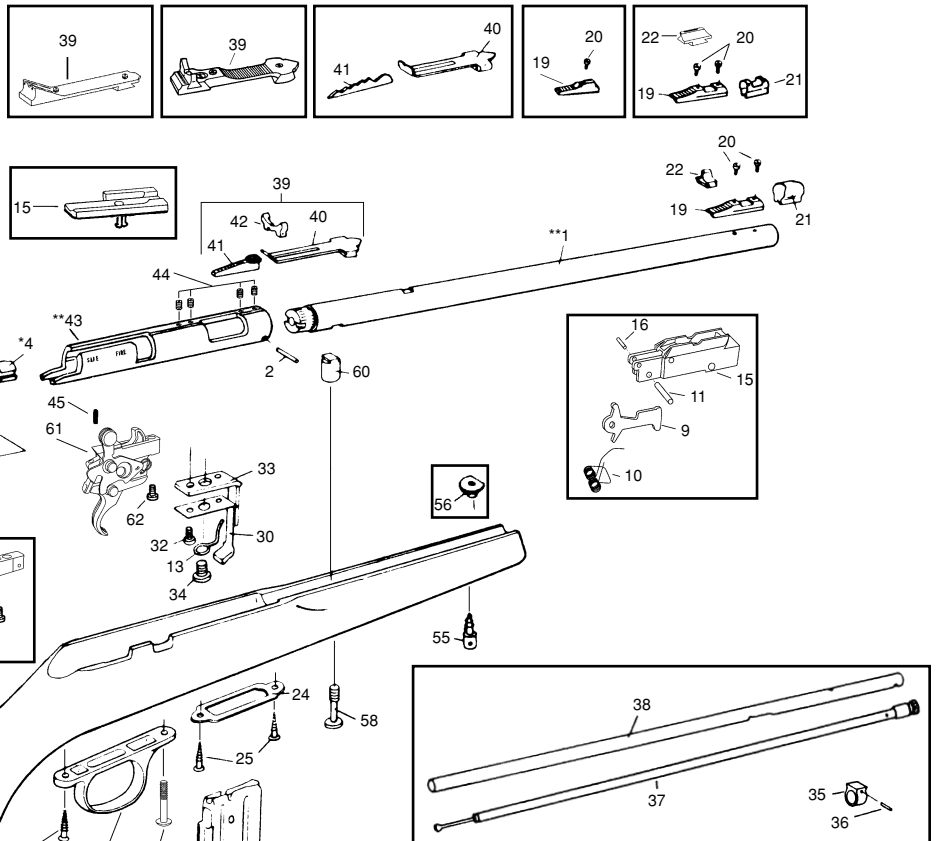

* Restricted availability—Part sent to qualified gunsmith only.

** Restricted availability—Parts installed at factory only.

*** Non-restricted availability—Part may require some final fitting sanding or filing.

PARTS LIST

BOLT ACTION RIMFIRE RIFLE

For parts prices, call 1-800-544-8892 (8 A.M. to 4:30 P.M., Eastern Time, Weekdays)
Be sure to mention gun serial number when ordering parts

ILL. NO. PART NAME

**1	Barrel
2	Barrel Retaining Pin
3	Breech Bolt Assembly Pin
*4	Breech Bolt, Front
*5	Breech Bolt, Rear
**6	Bullseye
***7	Buttplate/Butt pad
8	Buttplate Screw (2)
9	Cartridge Lifter
10	Cartridge Lifter and Ejector Spring
11	Cartridge Lifter Pivot Pin
12	Cartridge Lifter Spring
13	Ejector
***14	Extractor
15	Feed Ramp/Feed Throat
16	Feed Throat Assembly Pin
*17	Firing Pin
18	Firing Pin Spring
19	Front Sight Base
20	Front Sight Base Screw
21	Front Sight Hood
22	Front Sight Insert
23	Magazine Complete
24	Magazine Guard Plate
25	Magazine Guard Plate Screw (2)
26	Magazine Guide
27	Magazine Guide & Latch Assembly Pin
28	Magazine Guide Pivot Pin
29	Magazine Guide Screw
30	Magazine Latch
31	Magazine Latch and Ejector
32	Magazine Latch Screw

ILL. NO. PART NAME

33	Magazine Mounting Bracket
34	Magazine Mounting Bracket Screw
35	Magazine Tube Band
36	Magazine Tube Band Pin
37	Magazine Tube Inside Assembly
38	Magazine Tube Outside
39	Rear Sight Assembly
40	Rear Sight Base
41	Rear Sight Elevator
42	Rear Sight Folding Leaf
**43	Receiver
44	Scope Mount Dummy Screws (4)
45	Sear Spring
46	Stock
47	Striker
48	Striker Assembly Pin
49	Striker Cam Bushing
50	Striker Cam Pin
51	Striker Knob
52	Striker Retaining Screw
53	Striker Sleeve
54	Striker Spring
55	Swivel Stud, Front
56	Swivel Stud, Nut
57	Swivel Stud, Rear
58	Takedown Screw, Front
59	Takedown Screw, Rear
60	Takedown Screw, Stud
61	Trigger Group
62	Trigger Group Screw
63	Trigger Guard
64	Trigger Guard Screw

ILL. NO.	PART NAME	982 Part No.	982L Part No.	982S Part No.	982VS Part No.	980S Part No.	980V Part No.	925 Part No.	925C Part No.	925M Part No.	925MC Part No.	917V Part No.	917VS Part No.	981T Part No.	983T Part No.	983 Part No.	983S Part No.	915YS Part No.	915Y Part No.	917M2 Part No.	917M2S Part No.	
**1	Barrel	175730	175830	175230	175530	174830	174040	174220	174220	175520	175520	175043	175044	176830	176131	176130	176030	173921	173920	174045	174046	
2	Barrel Retaining Pin	430397	430397	430397	430397	430397	430397	430397	430397	430397	430397	430397	430397	430397	430397	430397	430397	430397	430397	430397	430397	430397
3	Breech Bolt Assembly Pin	430597	430597	430597	430597	430597	430597	430597	430597	430597	430597	430597	430597	430597	430597	430597	430597	430597	430597	430597	430597	430597
*4	Breech Bolt, Front	105186	105186	105186	105186	104886	104386	104386	104386	105186	105186	105186	105186	104586	105586	105586	105586	203887	203886	203386	104386	104886
*5	Breech Bolt, Rear	520486	520486	505986	505986	505986	520486	520486	520486	520486	520486	520486	505986	520486	520486	520486	505986	505986	520486	520486	505986	505986
***6	Bullseye	320101	320101	N/A	N/A	N/A	N/A	N/A	N/A	N/A	N/A	N/A	N/A	320101	N/A	N/A	320101	320101	N/A	N/A	N/A	320101
***7	Buttplate/Butt pad	417002	417002	N/A	N/A	N/A	N/A	320402	320402	320402	320402	320402	407102	N/A	N/A	417002	417002	320402	320402	320402	320402	407102
8	Buttplate Screw (2)	420590	420590	N/A	N/A	N/A	N/A	420590	420590	420590	420590	420590	420590	N/A	N/A	420590	420590	420590	420590	420590	420590	420590
9	Cartridge Lifter	N/A	N/A	N/A	N/A	N/A	N/A	N/A	N/A	N/A	N/A	N/A	N/A	305487	305287	305287	305387	N/A	N/A	N/A	N/A	N/A
10	Cartridge Lifter and Ejector Spring	N/A	N/A	N/A	N/A	N/A	N/A	N/A	N/A	N/A	N/A	N/A	N/A	404194	N/A	N/A	N/A	N/A	N/A	N/A	N/A	N/A
11	Cartridge Lifter Pivot Pin	N/A	N/A	N/A	N/A	N/A	N/A	N/A	N/A	N/A	N/A	N/A	N/A	306197	405198	405198	405198	N/A	N/A	N/A	N/A	N/A
12	Cartridge Lifter Spring	N/A	N/A	N/A	N/A	N/A	N/A	N/A	N/A	N/A	N/A	N/A	N/A	N/A	405295	405295	405394	N/A	N/A	N/A	N/A	N/A
13	Ejector	305068	305068	305068	305068	N/A	N/A	N/A	N/A	305068	305068	305068	305068	N/A	N/A	N/A	N/A	304168	304168	N/A	N/A	N/A
***14	Extractor	305547	305547	305647	305647	305647	305547	305547	305547	305547	305547	305547	305647	305547	305547	305547	305647	305647	305547	305547	305547	305647
15	Feed Ramp/Feed Throat	N/A	N/A	N/A	N/A	N/A	N/A	N/A	N/A	N/A	N/A	N/A	N/A	306189	205185	205185	205185	403285	403285	N/A	N/A	N/A
16	Feed Throat Assembly Pin	N/A	N/A	N/A	N/A	N/A	N/A	N/A	N/A	N/A	N/A	N/A	N/A	405298	N/A	N/A	N/A	N/A	N/A	N/A	N/A	N/A
*17	Firing Pin	220599	220599	205099	205099	205099	220599	220599	220599	220599	220599	220599	220599	220599	220599	220599	220599	220599	220599	220599	220599	220599
18	Firing Pin Spring	420994	420994	420994	420994	420994	420994	420994	420994	420994	420994	420994	420994	420994	420994	420994	420994	420994	420994	420994	420994	420994
19	Front Sight Base	221339	221339	220339	N/A	220939	N/A	330144	330144	330144	330144	N/A	N/A	330144	330144	221339	221439	220399	330144	N/A	N/A	N/A
20	Front Sight Base Screw	320991	320991	320190	N/A	321091	N/A	320593	320593	320593	320593	N/A	N/A	320593	320593	320991	321091	320190	320593	N/A	N/A	N/A
21	Front Sight Hood	320245	320245	320345	N/A	320345	N/A	N/A	N/A	N/A	N/A	N/A	N/A	N/A	N/A	320245	320345	320345	N/A	N/A	N/A	N/A
22	Front Sight Insert	230744	230744	407444	N/A	407444	N/A	N/A	N/A	N/A	N/A	N/A	N/A	N/A	N/A	230744	407444	N/A	N/A	N/A	N/A	N/A
23	Magazine Complete	405146	405146	405246	405246	404346	407846	407846	407846	405146	405146	405146	405246	N/A	N/A	N/A	N/A	N/A	N/A	407846	404346	404346
24	Magazine Guard Plate	305247	305247	305347	305347	304447	304347	304347	304347	305247	305247	305247	305347	N/A	N/A	N/A	N/A	N/A	N/A	N/A	304347	304447
25	Magazine Guard Plate Screw (2)	310790	310790	304491	304491	304491	310790	310790	310790	310790	310790	310790	304491	N/A	N/A	N/A	N/A	N/A	N/A	310790	304491	304491
26	Magazine Guide	N/A	N/A	N/A	N/A	404249	404249	404249	404249	N/A	N/A	N/A	N/A	N/A	N/A	N/A	N/A	N/A	N/A	N/A	404249	404249
27	Magazine Guide & Latch Assembly Pin	N/A	N/A	N/A	N/A	404297	404297	404297	404297	N/A	N/A	N/A	N/A	N/A	N/A	N/A	N/A	N/A	N/A	N/A	404297	404297
28	Magazine Guide Pivot Pin	N/A	N/A	N/A	N/A	404397	404397	404397	404397	N/A	N/A	N/A	N/A	N/A	N/A	N/A	N/A	N/A	N/A	N/A	404397	404397
29	Magazine Guide Screw	N/A	N/A	N/A	N/A	304391	304090	304090	304090	N/A	N/A	N/A	N/A	N/A	N/A	N/A	N/A	N/A	N/A	N/A	304090	304391
30	Magazine Latch	305048	305048	305148	305148	N/A	N/A	N/A	N/A	305048	305048	305048	305148	N/A	N/A	N/A	N/A	N/A	N/A	N/A	N/A	N/A
31	Magazine Latch and Ejector	N/A	N/A	N/A	N/A	304348	304148	304148	304148	N/A	N/A	N/A	N/A	N/A	N/A	N/A	N/A	N/A	N/A	304148	304348	304348
32	Magazine Latch Screw	320592	320592	305492	305492	N/A	N/A	N/A	N/A	320592	320592	320592	305492	N/A	N/A	N/A	N/A	N/A	N/A	N/A	N/A	N/A
33	Magazine Mounting Bracket	305049	305049	305149	305149	N/A	N/A	N/A	N/A	305049	305049	305049	305149	N/A	N/A	N/A	N/A	N/A	N/A	N/A	N/A	N/A
34	Magazine Mounting Bracket Screw	305092	305092	305392	305392	N/A	N/A	N/A	N/A	305092	305092	305092	305392	N/A	N/A	N/A	N/A	N/A	N/A	N/A	N/A	N/A
35	Magazine Tube Band	N/A	N/A	N/A	N/A	N/A	N/A	N/A	N/A	N/A	N/A	N/A	N/A	220121	220121	220121	205021	N/A	N/A	N/A	N/A	N/A
36	Magazine Tube Band Pin	N/A	N/A	N/A	N/A	N/A	N/A	N/A	N/A	N/A	N/A	N/A	N/A	420698	420698	420698	305497	N/A	N/A	N/A	N/A	N/A
37	Magazine Tube Inside Assembly	N/A	N/A	N/A	N/A	N/A	N/A	N/A	N/A	N/A	N/A	N/A	N/A	505222	505222	505222	505322	N/A	N/A	N/A	N/A	N/A
38	Magazine Tube Outside	N/A	N/A	N/A	N/A	N/A	N/A	N/A	N/A	N/A	N/A	N/A	N/A	205123	205123	205123	305320	N/A	N/A	N/A	N/A	N/A
39	Rear Sight Assembly	514142	514142	405241	N/A	520142	N/A	N/A	N/A	N/A	N/A	N/A	N/A	N/A	N/A	514142	520142	405241	N/A	N/A	N/A	N/A
40	Rear Sight Base	520241	520241	N/A	N/A	520041	N/A	220641	220641	220641	220641	N/A	N/A	220641	220641	520241	520041	N/A	305041	N/A	N/A	N/A
41	Rear Sight Elevator	320242	320242	N/A	N/A	330442	N/A	320942	320942	320942	320942	N/A	N/A	320942	320942	320242	330442	N/A	320942	N/A	N/A	N/A
42	Rear Sight Folding Leaf	214142	214142	N/A	N/A	214142	N/A	N/A	N/A	N/A	N/A	N/A	N/A	N/A	N/A	214142	214142	N/A	N/A	N/A	N/A	N/A
***43	Receiver	174003	174003	176003	176003	175005	174005	174005	174005	174003	174003	174003	176003	174008	174004	174004	176004	176001	174001	174005	174005	176005
44	Scope Mount Dummy Screws (4)	320690	320690	320006	320006	320006	320690	320690	320690	320690	320690	320690	320690	320690	320690	320690	320006	320006	320690	320690	320690	320006
45	Sear Spring	420395	420395	420395	420395	420395	420395	420395	420395	420395	420395	420395	420395	420395	420395	420395	420395	420395	420395	420395	420395	420395
46	Stock	505914	505714	404570	404870	404570	404370	504614	504000	504614	504000	504610	505710	404970	404470	505514	505314	503014	503014	504610	505710	505710
47	Striker	420154	420154	420154	420154	420154	420154	420154	420154	420154	420154	420154	420154	420154	420154	420154	420154	420154	420154	420154	420154	420154
48	Striker Assembly Pin	330197	330197	330197	330197	330197	330197	330197	330197	330197	330197	330197	330197	330197	330197	330197	330197	330197	330197	330197	330197	330197
49	Striker Cam Bushing	320253	320253	305252	305252	305252	320253	320253	320253	320253	320253	320253	305252	320253	320253	320253	305252	305252	320253	320253	305252	305252
50	Striker Cam Pin	320799	320799	305197	305197	305197	320799	320799	320799	320799	320799	320799	305197	320799	320799	320799	305197	305197	320799	320799	305197	305197
51	Striker Knob	220355	220355	220455	220455	220455	220355	220355	220355	220355	220355	220355	220455	220355	220355	220355	220455	220455	220355	220355	220355	220455
52	Striker Retaining Screw	320790	320790	305290	305290	305290	320790	320790	320790	320790	320790	320790	305290	320790	320790	320790	305290	305290	320790	320790	305290	305290
53	Striker Sleeve	320856	320856	305056	305056	305056	320856	320856	320856	320856	320856	320856	305056	320856	320856	320856	305056	305056	320856	320856	305056	305056
54	Striker Spring	420594	420594	420594	420594	420594	420594	420594	420594	420594	420594	420594	420594	420594	420594	420594	420594	420594	420594	420594	420594	420594
55	Swivel Stud, Front	420793	430193	N/A	N/A	N/A	N/A	420793	420793	420793	420793	420793	430293	N/A	N/A	420793	430293	N/A	N/A	420793	430293	430293
56	Swivel Stud, Nut	N/A	320352	N/A	N/A	N/A	N/A	N/A	N/A	N/A	N/A	N/A	320352	N/A	N/A	N/A	320352	N/A	N/A	N/A	N/A	320352
57	Swivel Stud, Rear	420793	420793	N/A	N/A	N/A	N/A	420793	420793	420793	420793	420793	305490	N/A	N/A	420793	305490	N/A	N/A	420793	305490	305490
58	Takedown Screw, Front	305390	305390	304291	304291	304291	32099															